

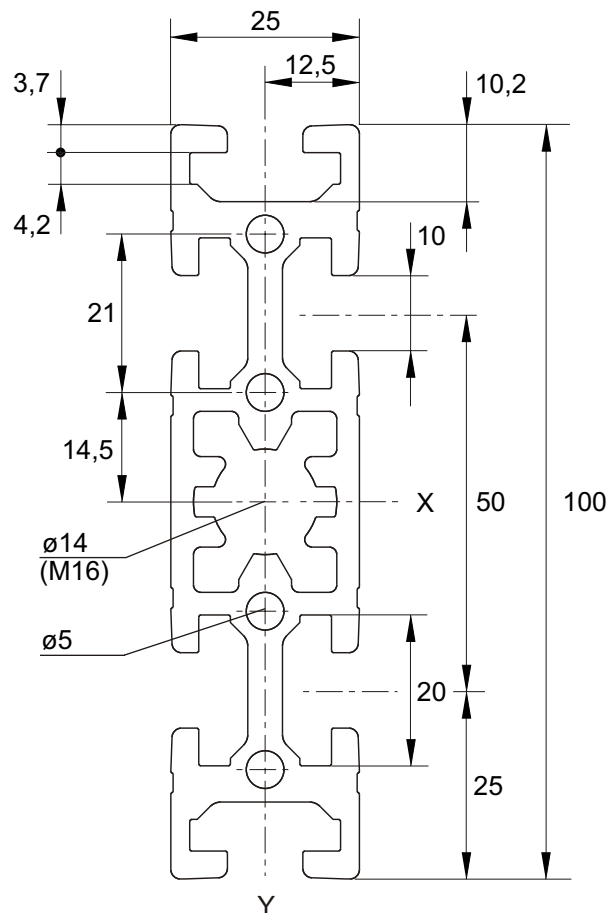

25 x 100

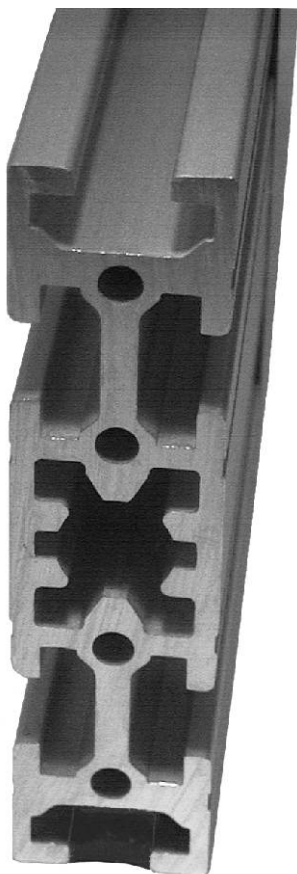



1 x 6000 mm				8000
10 x 6000 mm				8001
				8002/ mm
Ø 16,1 (1x)				8003/ mm
Ø 16,1 (1x)			Ø 16,1 (1x)	8004/ mm
M 16 x 100 (1x)				8009/ mm
M 16 x 100 (1x)			M 16 x 100 (1x)	8010/ mm
M 16 x 100 (1x)			Ø 16,1 (1x)	8013/ mm
45°; Ø 16,1 (1x)				8020/ mm
45°; Ø 16,1 (1x)			45°; Ø 16,1 (1x)	8023/ mm
Nach Bearbeitungsliste Seite 1.0.9-1.0.11 bzw. nach Ihrer Skizze. Compare outline of end finishing page res.1.0.9-1.0.11 according to your own sketch. Selon sommaire de usinage des extrémités page 1.0.9-1.0.11, ou de votre propre dessin. Conforme alla tabella lavorazione delle estremità pagina 1.0.9-1.0.11, rispet. schizzo costruttivo. Ver lista de mecanizar los extremos pagina 1.0.9-1.0.11 o bien segun un esbozo de Ud.				8099/ mm

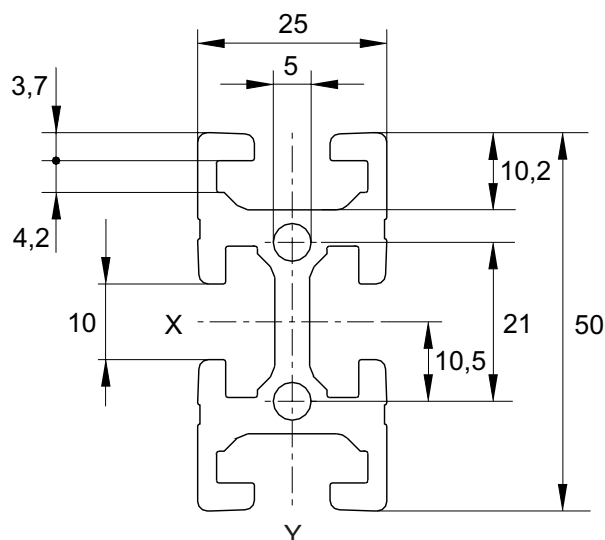

25 x 50

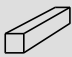

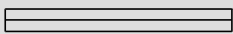
1 x 6000 mm		8100
10 x 6000 mm		8101
		8102/ mm
<p>Nach Bearbeitungsliste Seite 1.0.9-1.0.11 bzw. nach Ihrer Skizze. Compare outline of end finishing page res.1.0.9-1.0.11 according to your own sketch. Selon sommaire de usinage des extrémités page 1.0.9-1.0.11, ou de votre propre dessin. Conforme alla tabella lavorazione delle estremità pagina 1.0.9-1.0.11, rispet. schizzo costruttivo. Ver lista de mecanizar los extremos pagina 1.0.9-1.0.11 o bien segun un esbozo de Ud.</p>		8199/ mm