

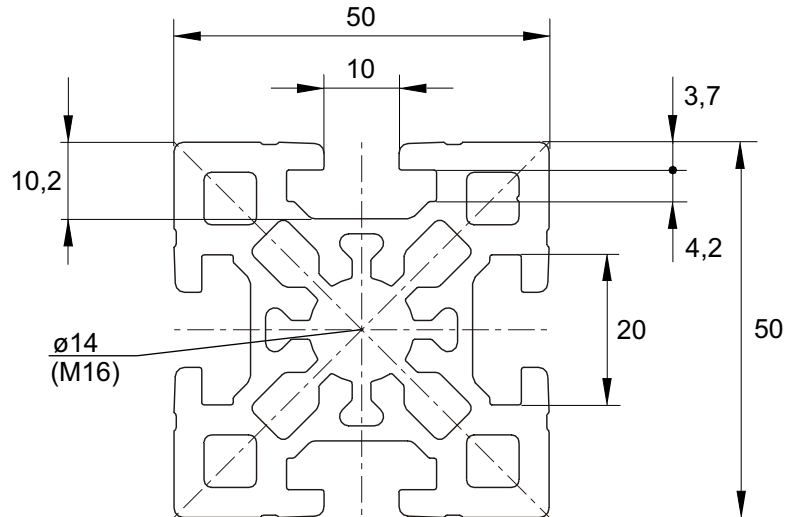

50 x 50 SW

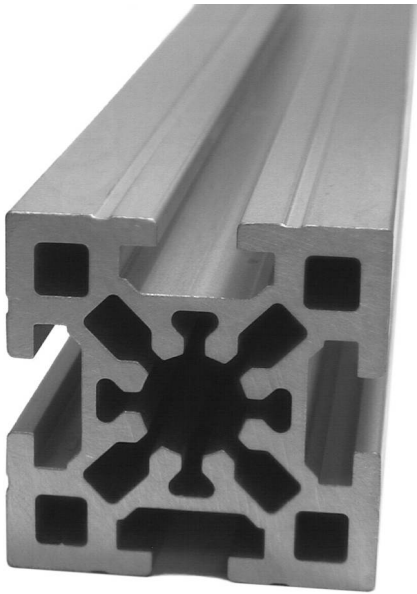

1 x 6000 mm			9000
10 x 6000 mm			9001
			9002/ mm
$\varnothing 16,1$ (1x)			9003/ mm
$\varnothing 16,1$ (1x)		$\varnothing 16,1$ (1x)	9004/ mm
M 16 x 100 (1x)			9009/ mm
M 16 x 100 (1x)		M 16 x 100 (1x)	9010/ mm
M 16 x 100 (1x)		$\varnothing 16,1$ (1x)	9013/ mm
45°; $\varnothing 16,1$ (1x)			9020/ mm
45°; $\varnothing 16,1$ (1x)		45°; $\varnothing 16,1$ (1x)	9023/ mm
Nach Bearbeitungsliste Seite 1.0.9-1.0.11 bzw. nach Ihrer Skizze. Compare outline of end finishing page res.1.0.9-1.0.11 according to your own sketch. Selon sommaire de usinage des extrémités page 1.0.9-1.0.11, ou de votre propre dessin. Conforme alla tabella lavorazione delle estremità pagina 1.0.9-1.0.11, rispet. schizzo costruttivo. Ver lista de mecanizar los extremos pagina 1.0.9-1.0.11 o bien segun un esbozo de Ud.			9099/ mm



50 x 100 SW

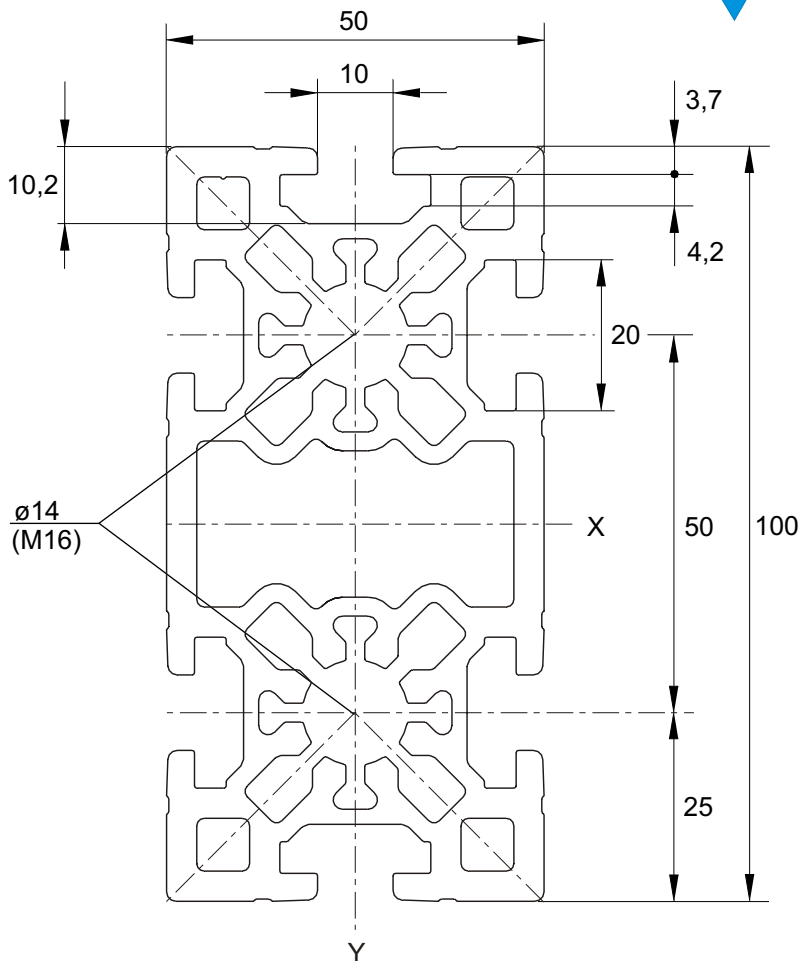
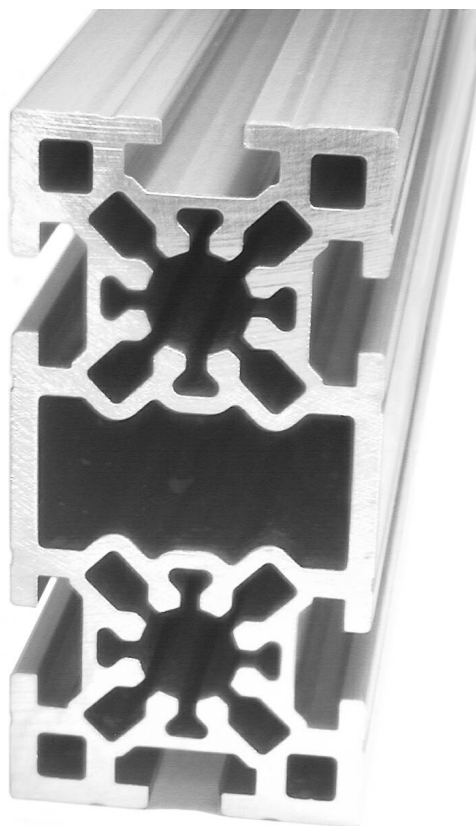

1 x 6000 mm			9100
10 x 6000 mm			9101
			9102/ mm
$\varnothing 16,1$ (2x)			9105/ mm
$\varnothing 16,1$ (2x)		$\varnothing 16,1$ (2x)	9106/ mm
$\varnothing 16,1$ (2x)			9107/ mm
$\varnothing 16,1$ (2x)		$\varnothing 16,1$ (2x)	9108/ mm
M 16 x 100 (2x)			9111/ mm
M 16 x 100 (2x)		M 16 x 100 (2x)	9112/ mm
45°; $\varnothing 16,1$ (2x)		45°; $\varnothing 16,1$ (2x)	9124/ mm
45°; $\varnothing 16,1$ (2x)		45°; $\varnothing 16,1$ (2x)	9125/ mm
Nach Bearbeitungsliste Seite 1.0.9-1.0.11 bzw. nach Ihrer Skizze. Compare outline of end finishing page res.1.0.9-1.0.11 according to your own sketch. Selon sommaire de usinage des extrémités page 1.0.9-1.0.11, ou de votre propre dessin. Conforme alla tabella lavorazione delle estremità pagina 1.0.9-1.0.11, rispet. schizzo costruttivo. Ver lista de mecanizar los extremos pagina 1.0.9-1.0.11 o bien segun un esbozo de Ud.			9199/ mm